



Date: 24-Nov-22 Author: Dillon Shantz 778-223-0493 Contractor: King Hoe Excavation
 Site Contact: Cody Garries - 604-866-9213 Date of Project: TBD Project Hours: TBD
 Scope of Work: Environmental Remediation Revision #: 01

Comments:

Yale Rd sign set up for truck access and egress to site

Sidewalk maintained
 Business access maintained

All specifications are based on the MOTi manual 2020 edition
 This plan is based on a 50 km/h roadway speed



Hocking Ave

Legend

- Bus Stop
- C-018-1A - Construction Ahead
- C-172-L - Truck Crossing - Left
- C-172-R - Truck Crossing - Right
- HLWD
- Site Access
- Site Egress
- Work Area

HLWD (Windmasters) required:

- on roads 70 km/h or higher
- sightlines and/or other obstructions exist
- instructed by TC supervisor, Contractor, or City
- for all REGULATORY signs used

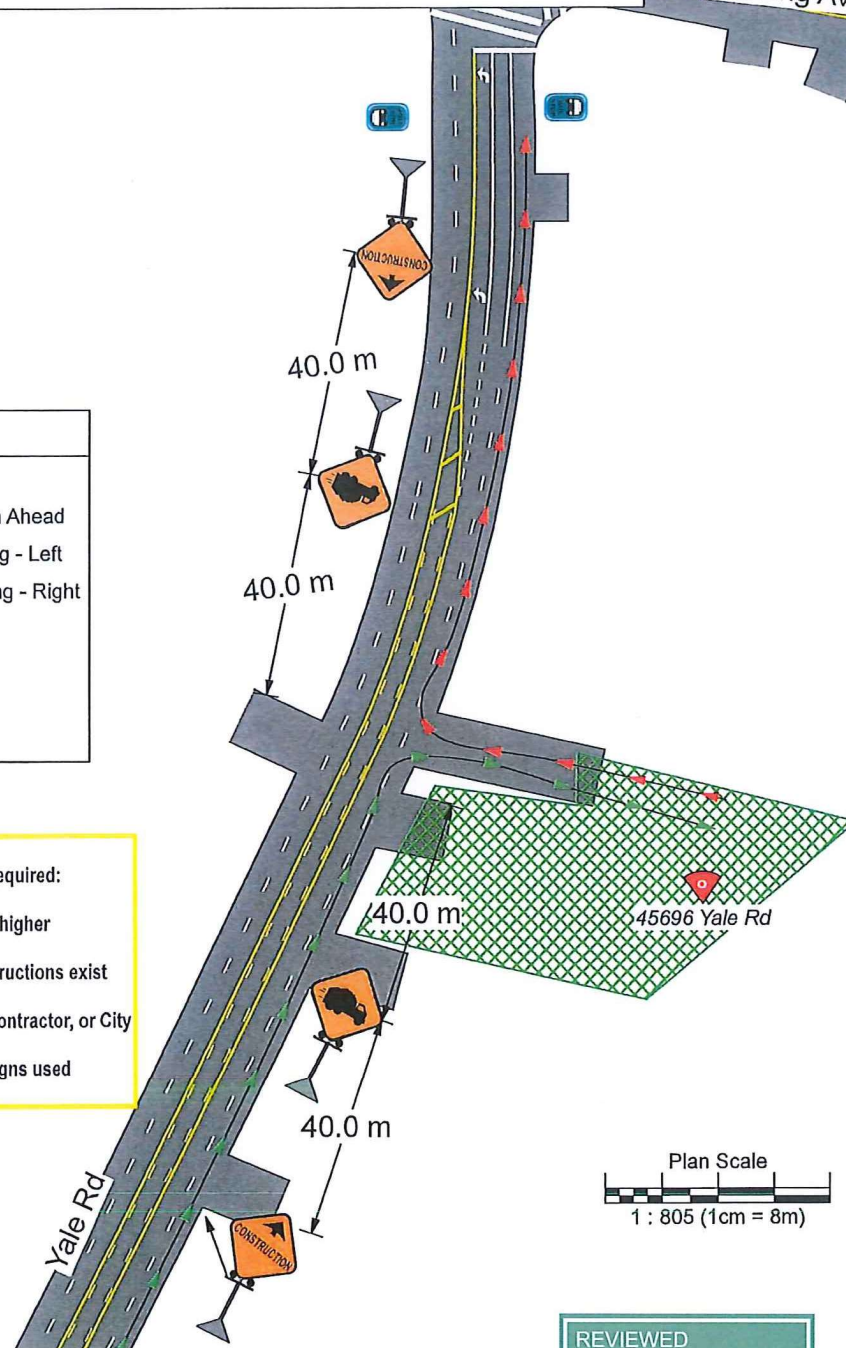

Plan Scale
 1 : 805 (1cm = 8m)

REVIEWED
 dumitru , 11/24/2022, 4:28:05 PM